

# INSTALLATION INSTRUCTIONS

Description:	<b>Fuel Gauge</b>	Part Number:	<b>99105-80003/80103</b>
Applications:	<b>Suzuki Marine Boats</b>	Installation Time:	<b>1 HRS</b>
NOTE:	<b>Mounts in standard 2 1/16" hole.</b>	Weight:	<b>1 lbs</b>

## Contents

Ref.	Part Number	Description	QTY
1.	99105-80003/80103	Fuel Gauge	1
2.	BC0037	Mounting Bracket	1
3.	Mounting Hardware		1

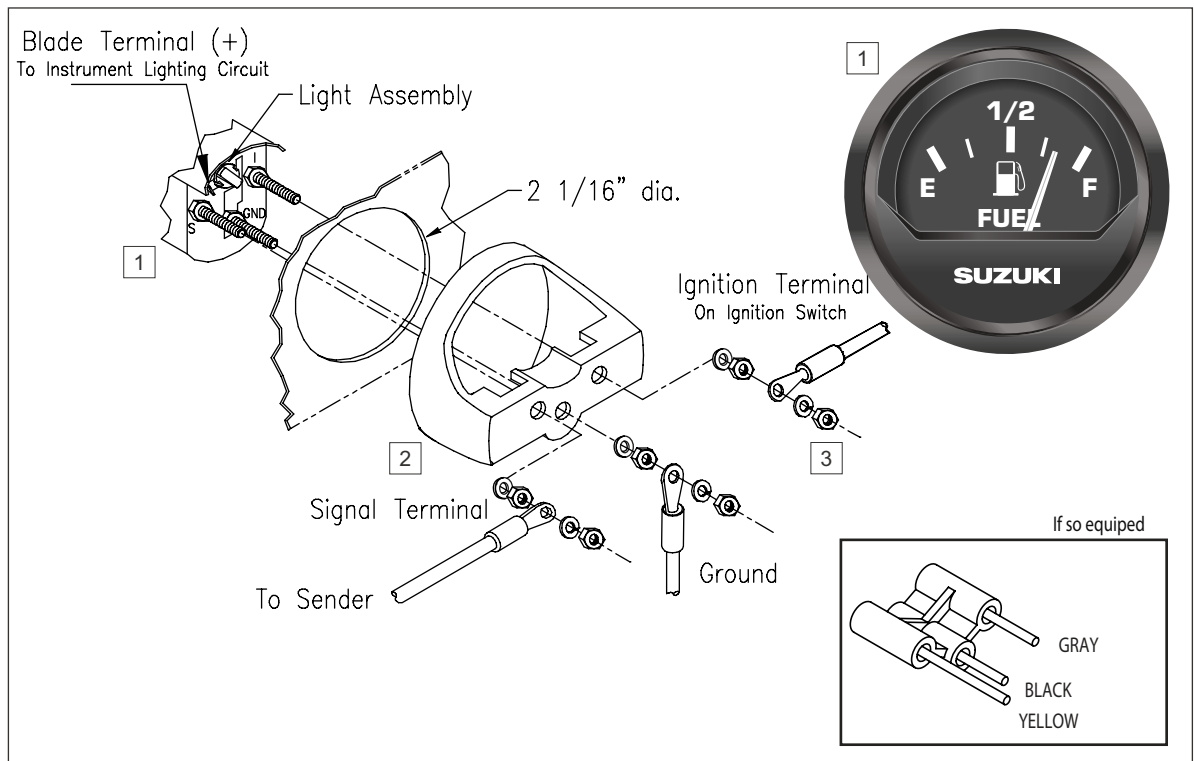

## Tools Required

Ref.	Tools Description
1.	3/8" Nut Driver
2.	Suzuki Terminal Kit 09900-28701



## Important

- ⚠ WARNING**
- ⚠ CAUTION**
- NOTE**

Please read this manual and follow its instructions carefully. To emphasize special information, the symbol **⚠** and the words **WARNING**, **CAUTION** and **NOTE** have special meanings. Pay special attention to the messages highlighted by these signal words:

**NOTE:** Indicates special information to make maintenance easier or instructions clear.

**⚠ WARNING**  
Indicates potential hazard that could result in death or injury.

**⚠ CAUTION**  
Indicates potential hazard that could result in vehicle damage.



## CAUTION

- Disconnect battery during installation.
- Tighten nuts on backclamp only slightly more than you can tighten with your fingers. Six inch-pounds of torque is sufficient. Over tightening may result in damage to the instrument and may void your warranty.
- Gasket cement or other adhesive is not required to secure tubing to fittings.

## Preparation Prior to Installation

- 1.** SPECIAL CAUTION should be taken when working on or near tanks that have, or have had, fuel in them.
- 2.** Be certain to use stranded, insulated wire not lighter than 18 AWG that is approved for marine use. It is recommended that you use the included color coded wire extension leads.

## Installation

- 3.** Cut a 2 1/16" dia hole in the dash and mount the gauge with the backclamp supplied.
- 4.** If this gauge kit includes a three prong connector, slide the connector over the gauge studs. Connect the fuel tank sender wire to the signal wire. Connect the gray and black wires to the gray and black wires of the main engine harness. Proceed to step 8, otherwise go to step 5.
- 5.** Connect your fuel tank sender wire to the gauge stud marked 'S' (signal) and secure with nut and lockwasher. Connect opposite end to the fuel level sender's signal wire or terminal.
- 6.** Connect the gray extension lead stud connector to the positive (+) post of the tachometer and plug the bullet end into the gray wire of the main engine harness.
- 7.** Connect the black extension lead stud connector to the negative (-) post of the tachometer and plug the bullet end into the black wire of the main engine harness.
- 8.** Connect the GREEN/ORANGE extension lead to the blade terminal adjacent to the twist-out light assembly to the positive "+" side of the instrument lighting circuit and the bullet end to the boat lighting circuit. No separate ground is required for the lighting. Reconnect the battery.

**NOTE:** To change light bulb, twist out black socket assembly one-eighth turn counterclockwise until it pops out. Bulb pulls straight out of socket assembly. It is a GE No. 161 instrument lamp.

### Mounting Hardware Kit



<b>A</b>		<b>x 3</b>
<b>B</b>		<b>x 6</b>
<b>C</b>		<b>x 3</b>

Figure 1



# Harness Diagram

HN0413 rev A ecr 5609 8/05

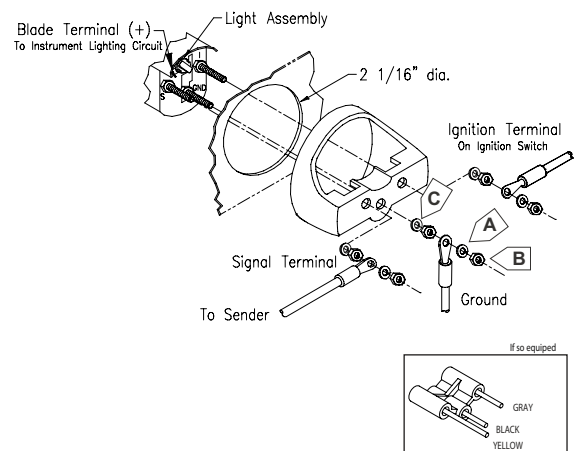
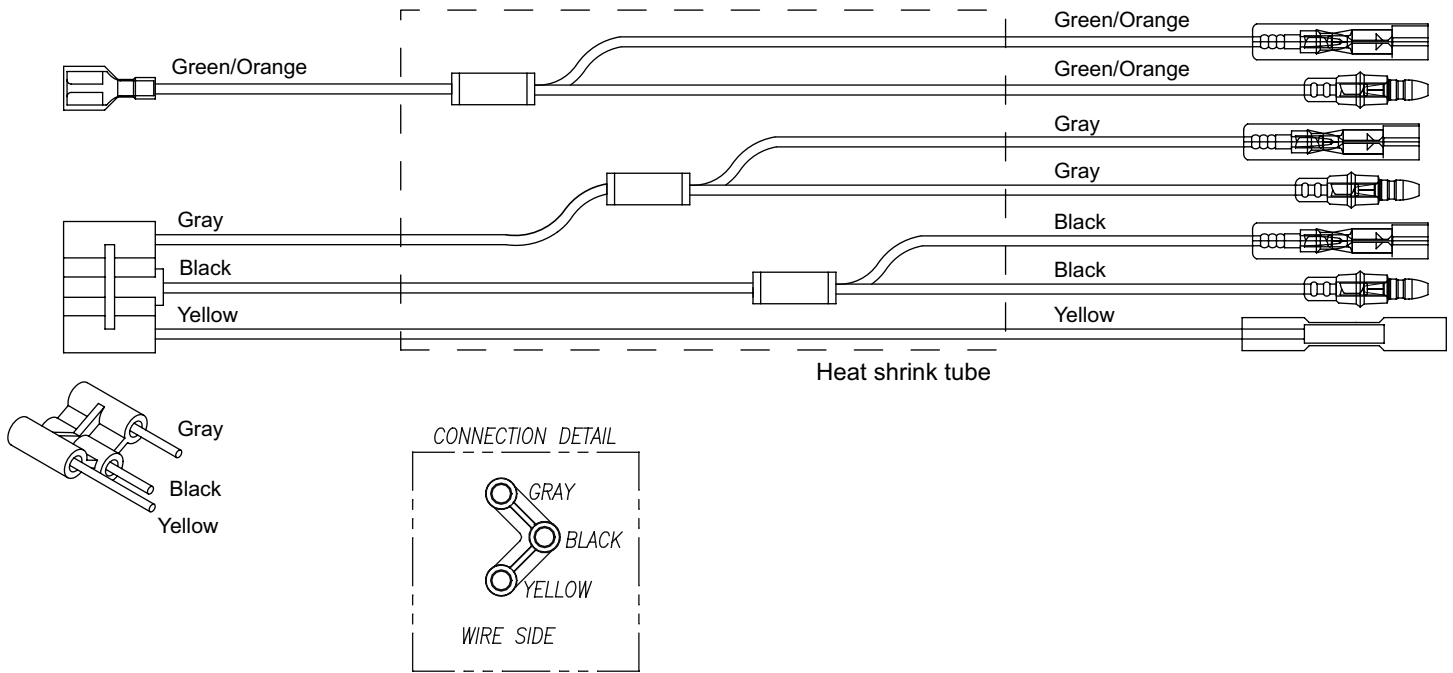

## Trouble Shooting

Trouble	Inspection	Diagnosis	Action
Gauge Sticks	A. Backclamp may be too tight.	1. Slightly loosen nuts holding backclamp. Check operation.	1. If gauge works and is not loose in panel, continue using gauge. 2. If gauge continues to stick, replace gauge.
Gauge Inoperative	A. Test for voltage to the gauge. Use voltmeter or test light.	1. Turn power on. Connect one lead to ignition terminal, the other to ground terminal.	1. If 12 volts present connections are good. 2. If 12 volts are not present at terminals, check for power at key switch or fuse block. If power available, replace leads to terminal.

